

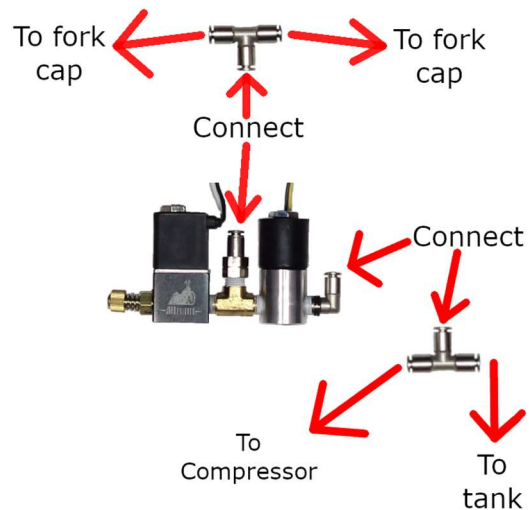

Front Air Fill/Dump Valve

Note: Empty all air out of the shocks before starting this procedure.

1. Connect the provided 1/4" tee to the existing 1/4" airline between the tank and compressor, then connect the 1/4" airline to the fill valve.
2. Connect the provided 5/32" tee to the fitting between the fill valve and dump valve and each fork cap.



3. Wire the fill valve (using the provide blade terminals if needed), connecting the yellow wire to the "Up" switch, and the black wire to ground.

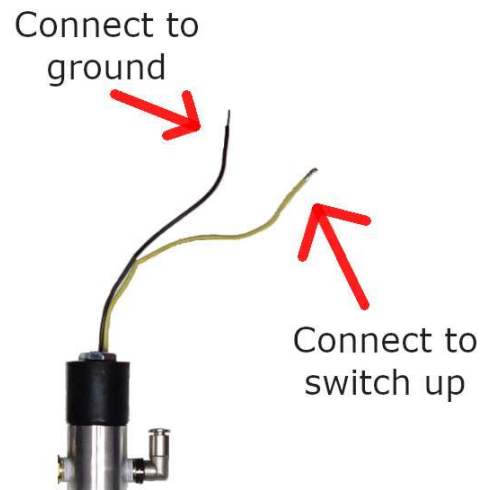

4. Wire the dump valve, connecting the white wire to the “Down” switch, and the black wire to ground.

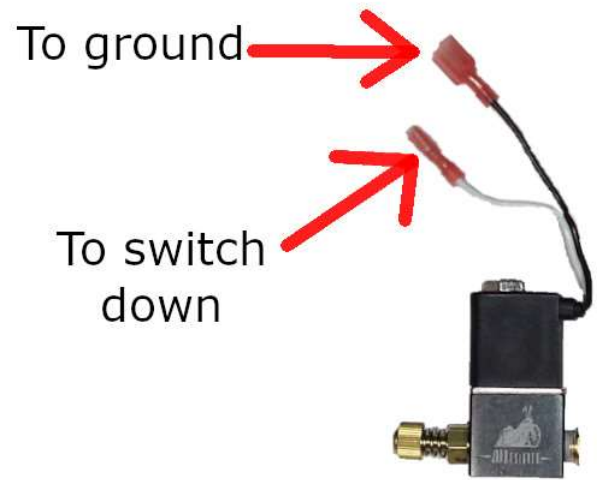

5. Adjust the speed control knob on the dump valve to control the drop rate when dumping air from the forks.

